

ASSEMBLY PART NUMBER	COLOR	KEYING OPTION	DIMENSIONS		CAVITY TYPE & STATUS (X = PLUGGED)									
			A	B	1	2	3	4	5	6	7	8		
33482-0801	BLACK	A	60	60										
33482-0802	LT.GRAY	B	25	60										
33482-0803	BROWN	C	60	25										
33482-0804	GREEN	D	25	25										
33482-0805	CUSTOM	TBD												
33482-0806	BLACK	A	60	60					X					
33482-0807	LT.GRAY	B	25	60					X					
33482-0808	BROWN	C	60	25					X					
33482-0809	GREEN	D	25	25					X					
33482-0810	CUSTOM	TBD							X					
33482-0811	BLACK	A	60	60					X	X				
33482-0812	LT.GRAY	B	25	60					X	X				
33482-0813	BROWN	C	60	25					X	X				
33482-0814	GREEN	D	25	25					X	X				
33482-0815	CUSTOM	TBD							X	X				
33482-0816	BLACK	A	60	60	X				X	X				
33482-0817	LT.GRAY	B	25	60	X				X	X				
33482-0818	BROWN	C	60	25	X				X	X				
33482-0819	GREEN	D	25	25	X				X	X				
33482-0820	CUSTOM	TBD			X				X	X				
33482-0821	BLACK	A	60	60	X				X	X			X	
33482-0822	LT.GRAY	B	25	60	X				X	X			X	
33482-0823	BROWN	C	60	25	X				X	X			X	
33482-0824	GREEN	D	25	25	X				X	X			X	
33482-0825	CUSTOM	TBD			X				X	X			X	
33482-0826	BLACK	A	60	60	X	X	X				X	X	X	
33482-0827	BLACK	A	60	60										X
33482-0828	BLACK	A	60	60				X	X					
33482-0829	BLACK	A	60	60		X	X	X	X	X	X	X	X	
33482-0830	BLACK	A	60	60								X		
33482-0831	BLACK	A	60	60			X	X	X					
33482-0832	BLACK	A	60	60						X	X	X	X	
33482-0833	BLACK	A	60	60	X		X	X						
33482-0834	BLACK	A	60	60	X	X	X	X	X	X	X	X	X	X

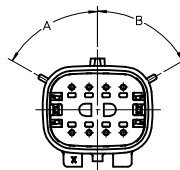

KEYING OPTION
SEE TABLE
SCALE 2:1

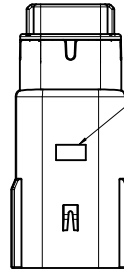

OPTIONAL TRACEABILITY
INFORMATION LOCATED IN
THIS AREA

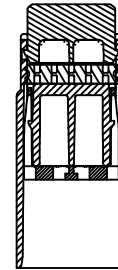

SECTION A-A

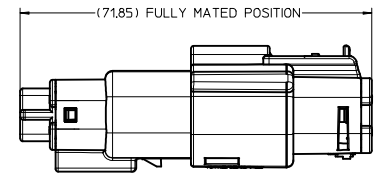

SCALE 1:1

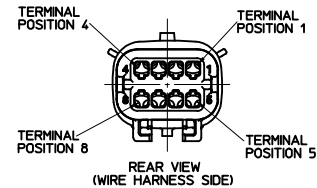

REAR VIEW
(WIRE HARNESS SIDE)

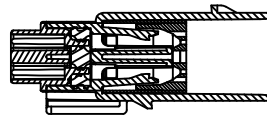

SECTION B-B
(BLADE SHOWN IN FULL-LOCK POSITION)
SEE NOTE 2

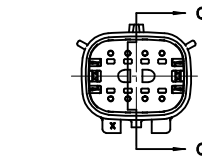
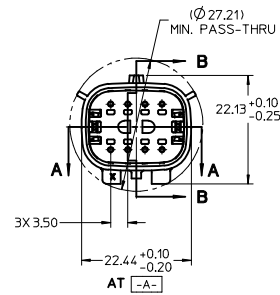

SECTION C-C
(BLADE SHOWN IN PRE-LOCK POSITION)
SEE NOTE 2

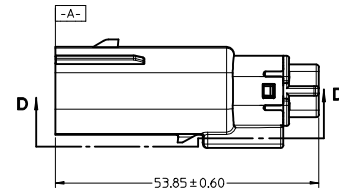

SECTION D-D

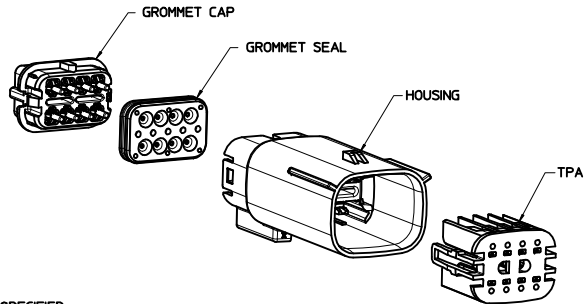

NOTES: UNLESS OTHERWISE SPECIFIED

- DESIGNED TO MATE WITH RECEPTACLE HOUSING ASSEMBLY SPECIFIED IN MOLEX CHARTED DRAWING SD-33472-081.
- ASSEMBLY SHIPPED WITH BLADE INSERT IN PRE-LOCK POSITION (SEE SECTION C-C PRE-LOCK). UPON FULL TERMINAL ASSEMBLY, EACH BLADE INSERT MUST BE SNAPPED INTO ITS FINAL-LOCK POSITION.
- FOR BLADE TERMINALS TO BE USED WITH THIS ASSEMBLY, SEE DRAWING SD-33000-001.
- SYSTEM TO BE USED WITH WIRE WITH DIAMETER RANGE OF 1.5mm TO 2.5mm.
- MATERIAL: SPS/NYLON BLEND, 20% GLASS FILLED.
- CHENGDU ASSEMBLIES SHALL CONFORM TO PACKAGING SPECIFICATION PK-31300-635
- SHALL CONFORM TO PRODUCT SPECIFICATION PS-33472-000.

REDRAWN IEC NO. UAU2009-0302 DRAWN BY: DMARCOUX CHECKED BY: DGRIFITHS APPROVED BY: FJHOLUB DATE: 2008/09/17 DATE: 2008/09/18 DATE: 2008/09/19	QUALITY SYMBOLS ▽=0 ▽=0	GENERAL TOLERANCES (UNLESS SPECIFIED)		DIMENSION STYLE MM ONLY	SCALE 2:1	DESIGN UNITS METRIC	THIRD ANGLE PROJECTION
		4 PLACES ± --- ± --- 3 PLACES ± --- ± --- 2 PLACES ± 0.10 ± --- 1 PLACE ± 0.3 ± --- ANGULAR ± 3 °	mm INCH	DRAWN BY: DMARCOUX DATE: 06-17-02 CHECKED BY: DGRIFITHS DATE: 06-17-02 APPROVED BY: FJHOLUB DATE: 06-17-02	TITLE MX150 BLADE CONNECTOR ASSEMBLY 2 ROW SEALED, 8 WAY	MOLEX INCORPORATED	
DRAFT WHERE APPLICABLE MUST REMAIN WITHIN DIMENSIONS		MATERIAL NO. AS NOTED		DOCUMENT NO. SD-33482-081		THIS DRAWING CONTAINS INFORMATION THAT IS PROPRIETARY TO MOLEX INCORPORATED AND SHOULD NOT BE USED WITHOUT WRITTEN PERMISSION	